

LEGENDA

- Existente
- Construir
- Demolir
- Reaproveitamento

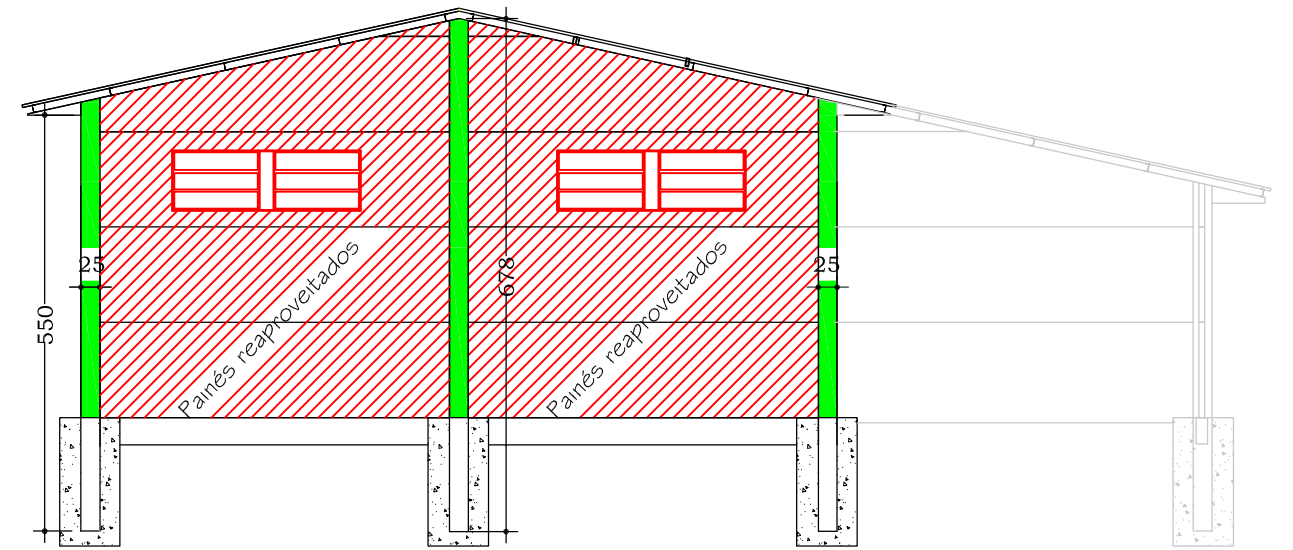

VISTA POSTERIOR
Esc: 1/100

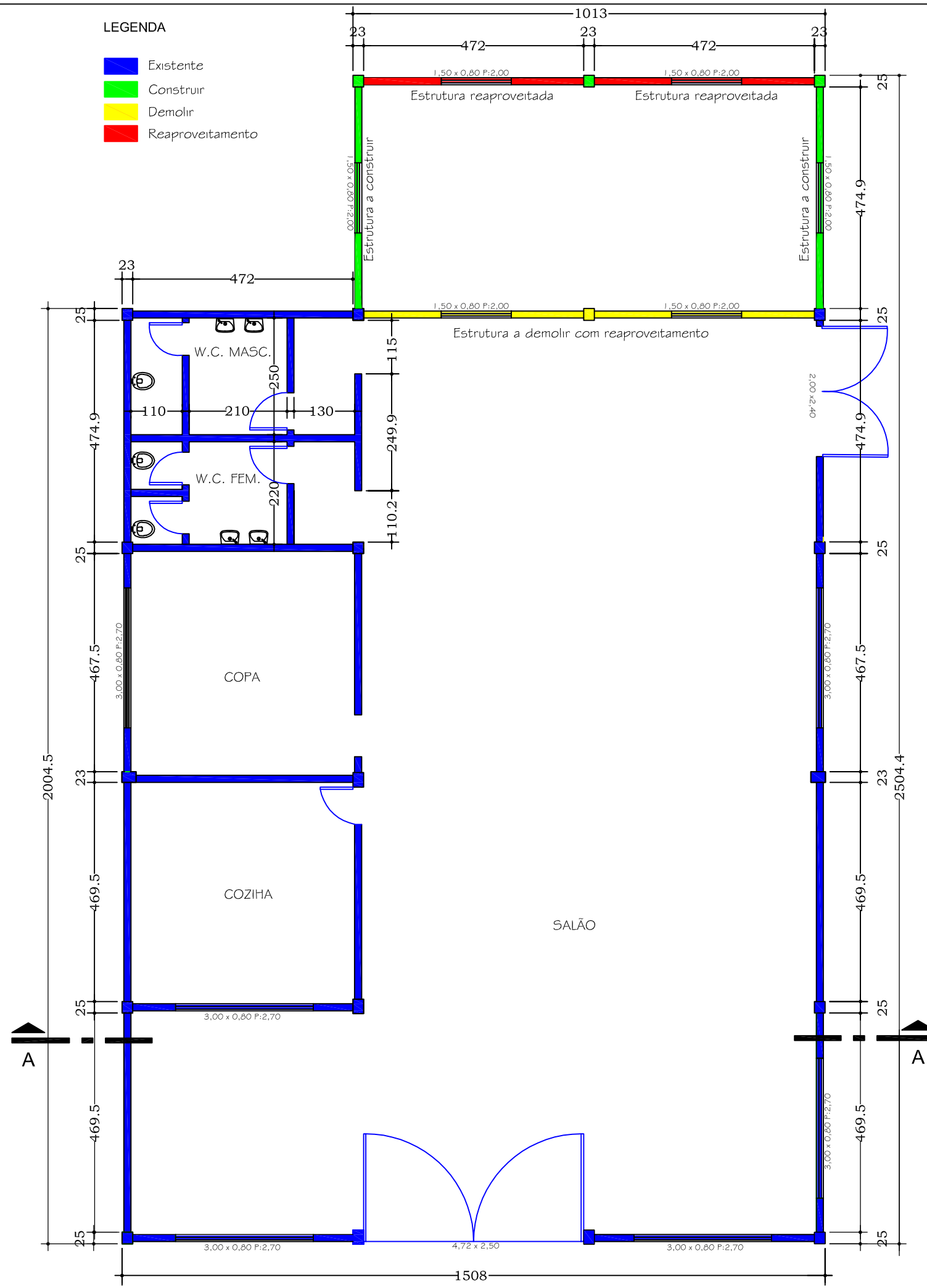
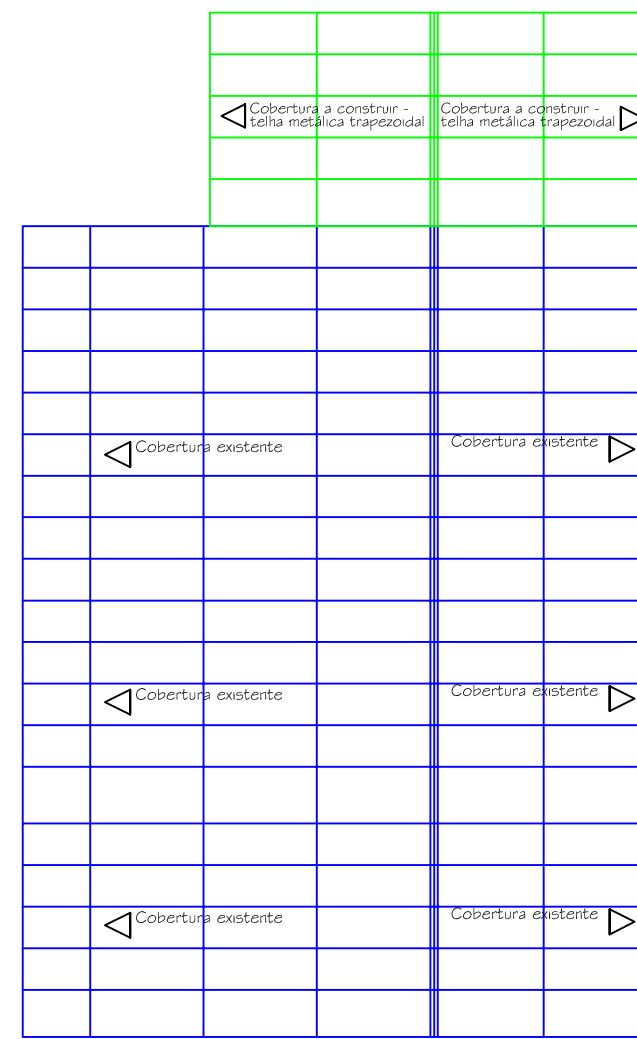

RESPONSÁVEL TÉCNICO: ARLINDO WULFF NETO ENG. CIVIL CREA-RS 213407	PREFEITURA MUNICIPAL DE JACUIZINHO	DATA: NOV/2023
PROPRIETÁRIO: DINIZ JOSÉ FERNANDES PREFEITO MUNICIPAL	PROJETO: AMPLIAÇÃO SALÃO COMUNITÁRIO PANTANINHO	ESCALA: 1/100
	LOCAL: PANTANINHO-JACUIZINHO/RS	PRANCHA: 01